

INSTRUCTIONS IMPORTANT SAFEGUARDS

When using electrical equipment, basic safety precautions should always be followed including the following:

CAUTION! ALWAYS MAKE SURE THE POWER IS TURNED OFF before starting the installation.

1. Measure, locate fixture's position, and mark locations for the brackets.
2. Secure brackets to ceiling as shown below. (HARDWARE BY OTHERS)
3. Wiring fixture to power supply, shall be performed by a certified electrician, and wired in a manner that complies with all local and national electrical codes, as well as the manufacturer's wiring diagram.
4. Proper replacement of a part removed for user maintenance.

HT: pg 1-3

SE: pg 4-7

SA: pg 8-11

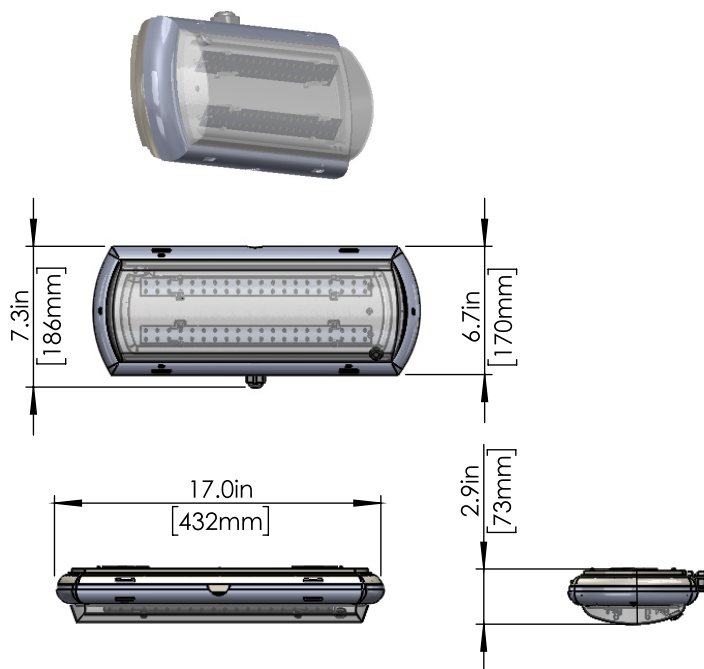

TEMPESTA HT UNV	
WATTAGE	17W
VOLTAGE	120-277V 50/60Hz
WET LOCATION	YES
OPERATION	HT (AC ONLY)
AMBIENT TEMPERATURE HT	-20°C (-4°F)/40°C (104°F)
WEIGHT	5 lbs
DIMENSION	17.0" X 6.7" X 3.0"

WIRING

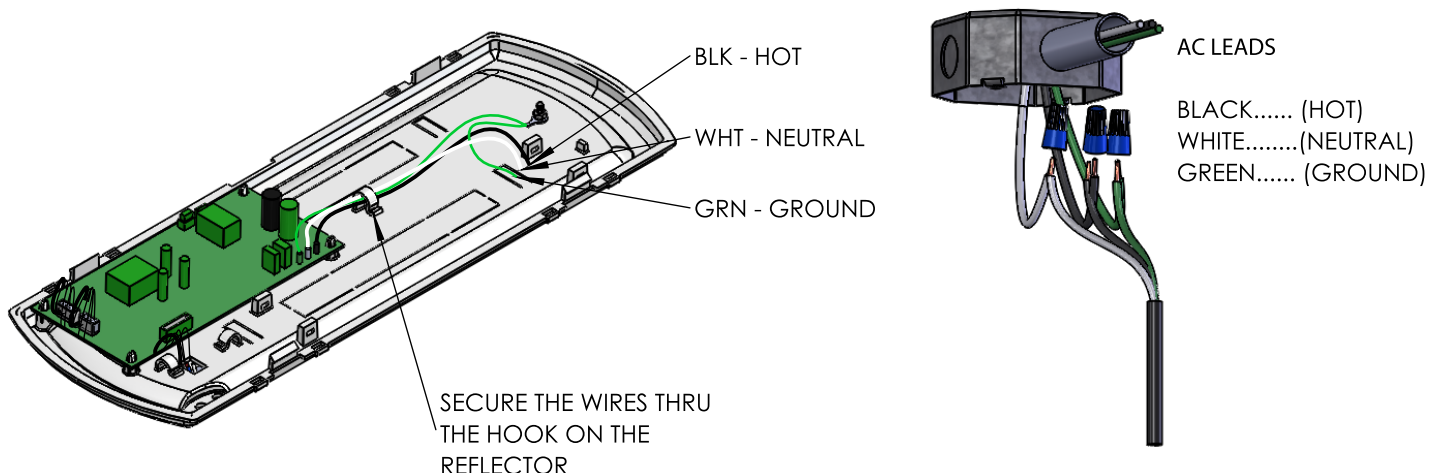

REMOVING LENS

SURFACE MTG.
(HARDWARE BY OTHERS)

(2) 1/2" TRADE SIZE KNOCK-OUTS

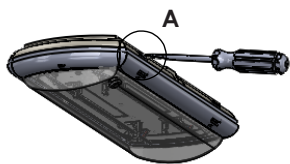

A. Using a flat head screwdriver, push-in to release lock (repeat for 3 other clips).

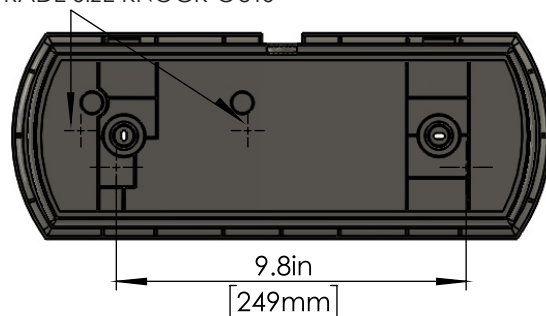
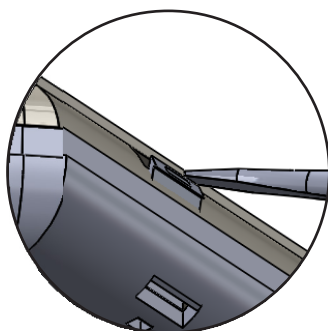

REMOVING ELECTRICAL ASSEMBLY



B. Using a flat head screwdriver, twist to release lock (repeat for 3 other clips).

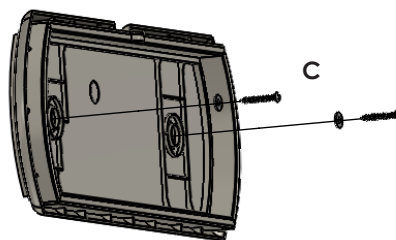
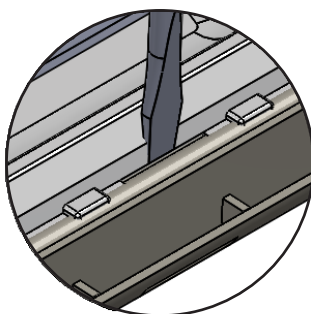

C. Install back plate on the wall at designated location (**hardware by others**).

T BAR MOUNTING (GRID CEILING)

TYPICAL GRID CEILING

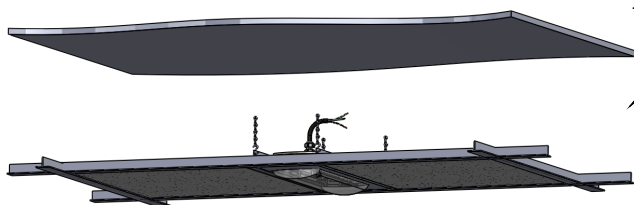

1. DROP THE FIXTURE INSIDE THE TRIM PLATE & SECURE IT WITH THE PROVIDED STRAP AND SCREWS.
2. DROP THE FIXTURE ASSEMBLY ON THE CEILING GRID.
3. CUT THE CEILING PANEL TO SIZE TO FILL-UP THE EMPTY SPACE.

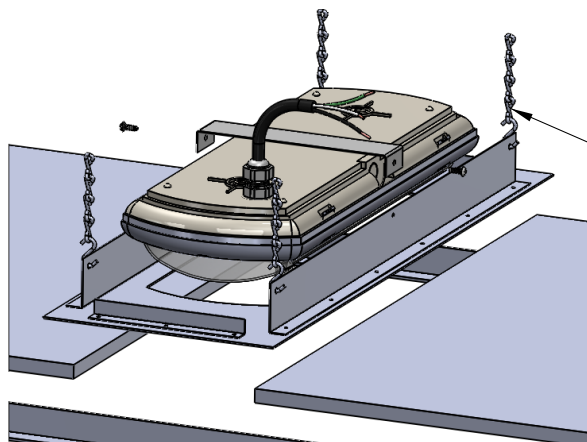

RECOMMEND CHAIN & HOOK ARE USE AS SAFETY DEVICES (**BY OTHERS**)

RECESSED MOUNTING

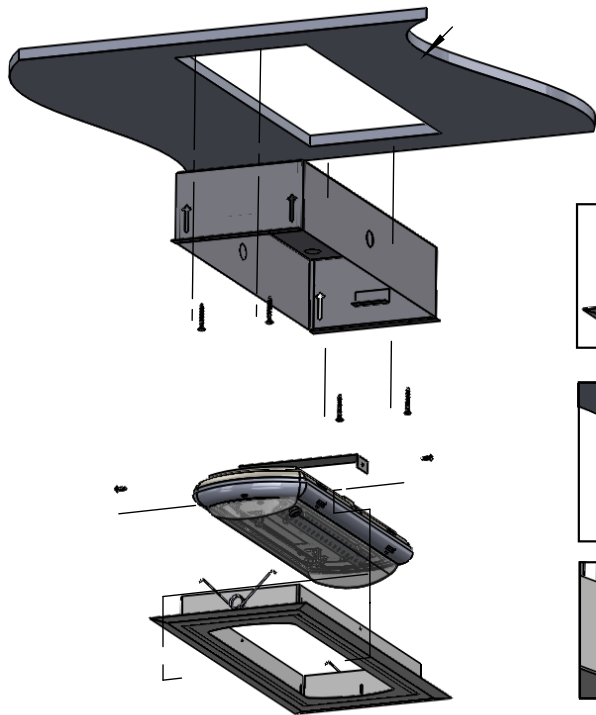

1. CEILING CUT OUT (SEE BACK BOX DIMENSION).
2. INSTALL BACK BOX AS SHOWN (HARDWARE BY OTHERS).
3. DROP THE FIXTURE INSIDE THE TRIM PLATE & SECURE IT WITH THE PROVIDED STRAP AND SCREWS.

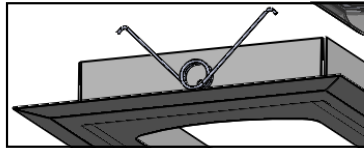

SQUEEZE SPRINGS TO ENGAGE RECTANGULAR HOLE IN THE BACK BOX

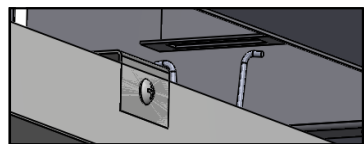
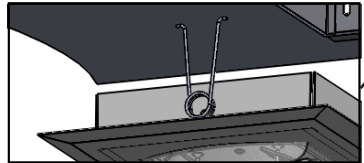

RECTANGULAR HOLE ON TAB INSIDE THE BACK BOX

WALL MOUNTING LED POSITION

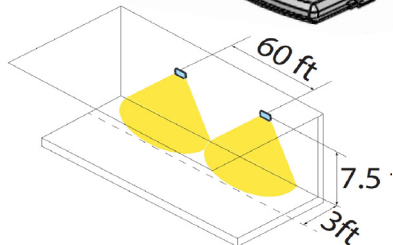
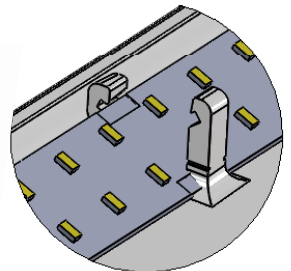
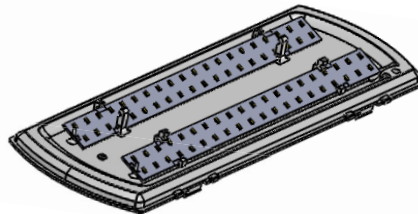
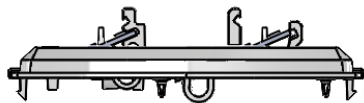
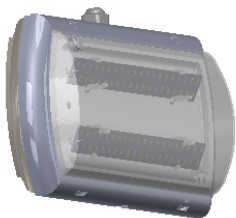

CEILING MOUNTING LED POSITION

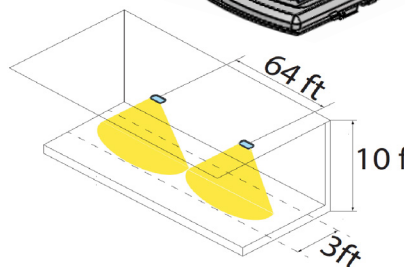
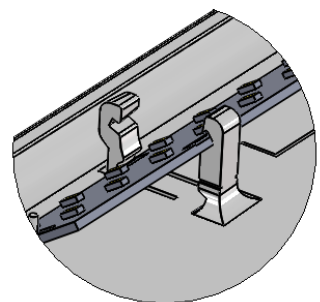
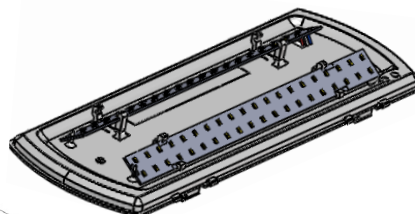
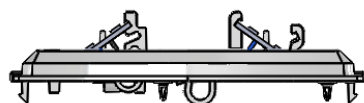

INSTRUCTIONS IMPORTANT SAFEGUARDS

When using electrical equipment, basic safety precautions should always be followed including the following:

CAUTION! ALWAYS MAKE SURE THE POWER IS TURNED OFF before starting the installation.

1. Measure, locate fixture's position, and mark locations for the brackets.
2. Secure brackets to ceiling as shown below. (HARDWARE BY OTHERS)
3. Wiring fixture to power supply, shall be performed by a certified electrician, and wired in a manner that complies with all local and national electrical codes, as well as the manufacturer's wiring diagram.
4. Proper replacement of a part removed for user maintenance.

HT: pg 1-3

SE: pg 4-7

SA: pg 8-11

IMPORTANT NOTES FOR INSTALLER:

MAXIMUM MOUNTING HEIGHT: 15FT

Proper replacement of a part removed for user maintenance

*Assembly instructions for a luminaire that requires partial assembly in the field
KEEP THESE INSTALLATION INSTRUCTIONS*

REMOVING LENS



USING FLAT HEAD SCREW DRIVER
PUSH-IN TO RELEASE LOCK
(REPEAT FOR OTHER 3 CLIPS)



(2) 1/2" TRADE SIZE KNOCK-OUTS

SURFACE MTG.
(HARDWARE BY OTHERS)

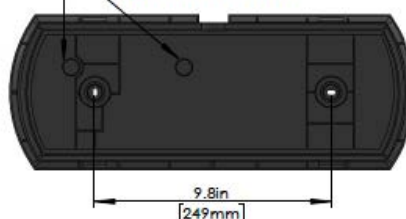

REMOVING ELECTRICAL ASSEMBLY



USING FLAT HEAD SCREW DRIVER TWIST TO RELEASE LOCK
(REPEAT FOR OTHER 3 CLIPS)



INSTALL BACK PLATE ON THE WALL AT
DESIGNATED LOCATION (HARDWARE
BY OTHERS); SNAP ON THE PROVIDED
WATER PROOF CAP
SEE WIRING ON NEXT PAGE

WIRING:

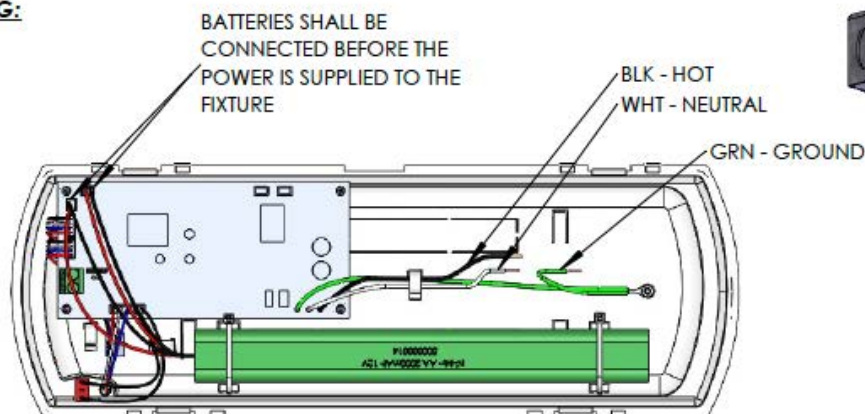

BATTERIES SHALL BE
CONNECTED BEFORE THE
POWER IS SUPPLIED TO THE
FIXTURE

BLK - HOT
WHT - NEUTRAL

GRN - GROUND



AC LEADS

BLACK..... (HOT)
WHITE..... (NEUTRAL)
GREEN..... (GROUND)

WALL MOUNT LED ORIENTATION (23°/23°)

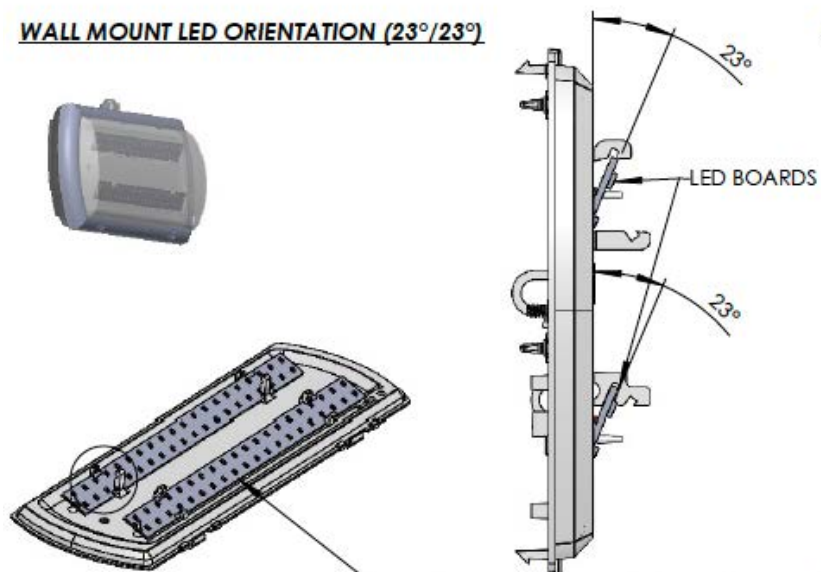

Proper replacement of a part removed for user maintenance.
Remplacement correct d'une pièce retirée pour la maintenance de l'utilisateur.

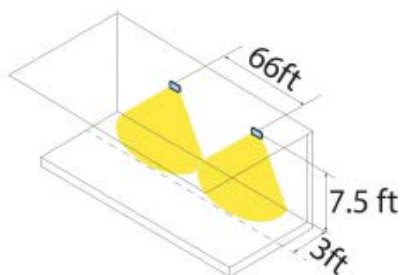
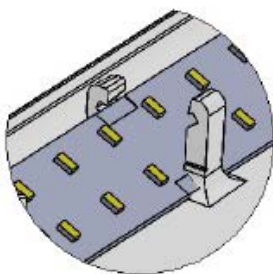

CEILING MOUNT LED ORIENTATION (35°/35°)

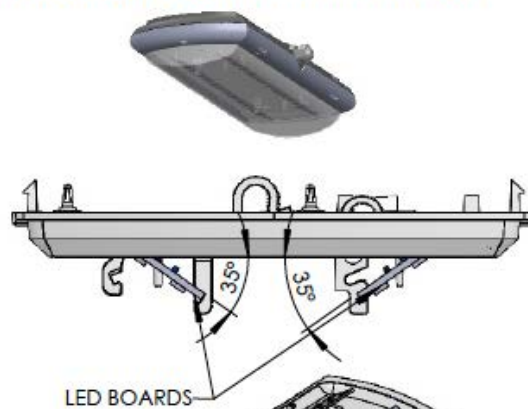

LED BOARDS

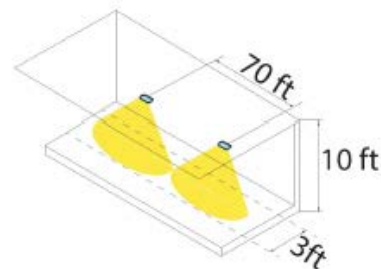
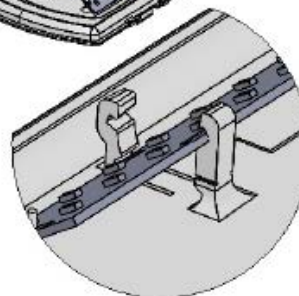
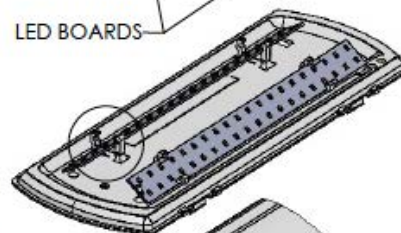

LED INDICATOR
TEST SWITCH
NORMALLY CLOSE (NC)

FOR NON-AUTO-TEST VERSION

SE - Press and hold the test switch; LED strips should be ON.



STEADY GREEN:
FLASHING RED/GREEN:
STEADY RED:

NORMAL OPERATION
HIGH CHARGING
BATTERY DISCONNECTED

INSTRUCTIONS
IMPORTANT SAFEGUARDS

When using electrical equipment, basic safety precautions should always be followed including the following:

- 1. READ AND FOLLOW ALL SAFETY INSTRUCTIONS.
- 2. Disconnect power before performing work on electrical equipment.
- 3. Do not let power cords touch hot surfaces and do not mount near gas or electric heaters.
- 4. Use caution when servicing batteries. Battery acid can cause burns to skin and eyes. If acid is spilled on skin or eyes, flush with fresh water and contact a physician immediately.
- 5. Equipment should be mounted in locations and at heights where unauthorized personnel will not readily subject it to tampering.
- 6. The use of accessory equipment not recommended by Beghelli Inc. may cause an unsafe condition and will void the unit's warranty.
- 7. Do not use the equipment for other than its intended purpose.
- 8. Servicing of this equipment should be performed by qualified service personnel.
- 9. SAVE THESE INSTRUCTIONS!

INSTRUCTIONS

After unit is properly installed according to Installation Instruction Sheet and with AC power supplied, the LED strips will be ON if it is a Normally On fixture (SA), the dual color LED indicator will be flashing red/green, until the battery is fully charged, and the self-diagnostic test function will automatically initiate. The dual color indicator points out the current unit status. The green color indicates the normal service/ green blinking indicates testing. The red color indicates the service alert, please refer to Diagnostic Display for detail. The green/red flash indicates the unit under charging. The indicator will be off at emergency mode.

SELF-DIAGNOSTIC SERVICE

The self-diagnostic function is factory pre-set. Any field adjustments are not required. The automatic self-diagnostic performs the following tests and the internal counter will begin from the date of installation:







- i) 5 minutes discharge and self-testing every 30 days; after AC power is applied.
- ii) 90 minutes discharge and self-testing every 6 months; after AC power is applied.

At all times the following are being monitored: Battery disconnection, LED failure, battery charging operation and the battery test failure.

NOTE: To change the self-testing time cycle OFF the fixture at the desired time.

DIAGNOSTIC DISPLAY

The Auto-Test Self-Diagnostics provides a visual indication of unit status via a multi-colored LED. The LED may indicate just one or any combination of various conditions as follows:

	STEADY GREEN:	NORMAL OPERATION
	FLASHING GREEN:	TESTING UNDER WAY
	FLASHING RED/GREEN:	HIGH CHARGING
	STEADY RED:	BATTERY DISCONNECTED
	FLASHING RED:	BATTERY TEST FAILURE
	RED DOUBLE BLINK:	BATTERY CHARGING FAILURE
	RED THREE BLINK:	LED FAILURE

MANUAL TESTING

The unit also provides manual testing by pressing the test button as follows. The testing can be stopped by pushing the button during the manual testing.

1. **30 sec. test:** Press **TEST** button **two times** (within 3 sec.)
 - The **GREEN** light will start flashing after 3 sec. and continue flashing during the remaining of the 30 sec. test.
 - If two presses of **TEST** button are not completed within 3 sec., this manual test will be ignored.
 - This test is always allowed.
2. **15 min. test:** Press **TEST** button **three times** (within 3 sec.)
 - The **GREEN** light will start flashing after 3 sec. and continue flashing during the remaining of the 15 min. test.
 - If three presses of **TEST** button are not completed within 3 sec., this manual test will be ignored.
 - This test is always allowed.
3. **90 min. test:** Press **TEST** button **four times** (within 3 sec.)
 - The **GREEN** light will start flashing after 3 sec. and continue flashing during the remaining of the 90 min. test.
 - If four presses of **TEST** button are not completed within 3 sec., this manual test will be ignored.
 - This test is always allowed when battery is fully charged, diagnostic LED shows steady **GREEN**.

Manual test can be stopped/aborted at any time by pushing **TEST** button once (lasting > 5 sec.), during the manual testing.

Note: MANUAL Test Modes of Ni-MH Charger Unit could be initiated only if any periodical Auto-Test is not under way. Otherwise pushing **TEST** button will be ignored.

If the battery fails on any of the above tests, an alarm signal of "Flashing Red" LED will be activated and displayed at all time until the LED board is reset, or any test has passed again.

If the diagnostic LED indicator does not light or the board malfunctions, resetting the LED board might clear all errors.

To reset the LED board:

2. Disconnect the battery and then disconnect the AC power.
3. Wait for 10 seconds, first reconnect the battery to the board and then resume AC power.

After exiting from MANUAL Test Mode a 24hr counter will be started to prevent any new AUTO/MANUAL test execution before 24hr of battery charging is performed or before battery is fully charged, whichever comes first, with the exception of 5 min. Auto-Test, 30 sec. or 15 min. manual test. However, any new emergency operation will be entered promptly, regardless of battery voltage level.

WARNING

4. Make sure that power is off before making any electrical connections!!!
5. Unused wires must be capped using provided wire nuts!

KEEP THESE INSTALLATION INSTRUCTIONS

INSTALLATION INSTRUCTION

IMPORTANT SAFEGUARDS

HT: pg 1-3

SE: pg 4-7

SA: pg 8-11

Read & Follow All Safety Instructions

When using electrical equipment, basic safety precautions should always be followed including:

1. Disconnect power before performing work on electrical equipment (using the light switch to turn off the power is not sufficient to prevent electrical shock)
2. Do not mount near gas or electric heaters
3. Do not install in unstable, loose or breakable surfaces and Do not let objects impact or exert force on the surface of the fixture
4. Use caution when servicing batteries (Battery acid can cause burns to skin and eyes; If acid is spilled on skin or eyes, flush with water and contact a physician immediately)
5. Equipment should be mounted in locations and at heights where it will not be subjected to tampering by unauthorized personnel
6. The use of accessory equipment not recommended by Beghelli Inc may cause an unsafe condition and will void the unit's warranty
7. Do not use this equipment for other than its intended purpose
8. Installation and servicing of this equipment should be performed by a qualified electrician familiar with the product and the hazards involved
9. Allow battery to charge for 24 hours before first use
10. To prevent wiring damage or abrasion, do not expose wiring to edges of sheet metal or other sharp objects



WARNING

1. Verify correct supply voltage by comparing it with the luminaire label information
2. All wiring connections should be capped with UL approved wire connectors
3. Use minimum 90°C Supply Wires



CAUTION

1. Avoid direct eye exposure to the light source while it is on
2. Beware- small parts and packing material may be hazardous to children
3. Risk of burn; Disconnect power and allow fixture to cool before handling fixture

SAVE THESE INSTRUCTIONS

REMOVING LENS



USING FLAT HEAD SCREW DRIVER
PUSH-IN TO RELEASE LOCK
(REPEAT FOR OTHER 3 CLIPS)

(2) 1/2" TRADE SIZE KNOCK-OUTS

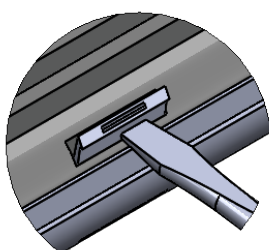

SURFACE MTG.
(HARDWARE BY OTHERS)

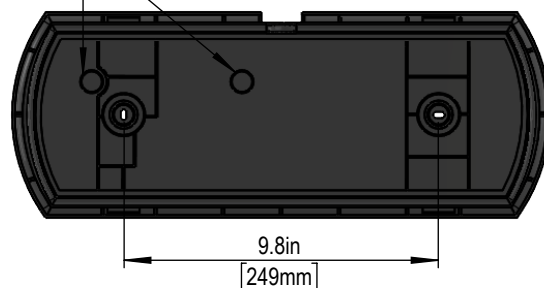

REMOVING ELECTRICAL ASSEMBLY

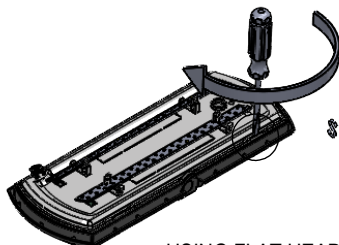

USING FLAT HEAD SCREW DRIVER TWIST TO RELEASE LOCK
(REPEAT FOR OTHER 3 CLIPS)

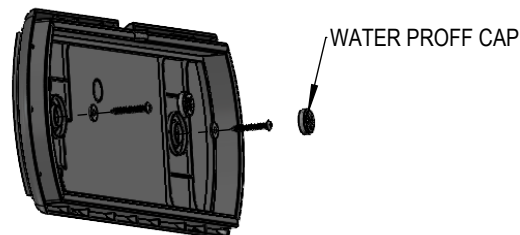
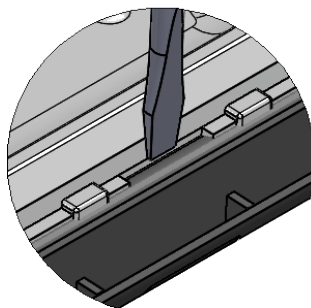

INSTALL BACK PLATE ON THE WALL AT
DESIGNATED LOCATION (HARDWARE BY
OTHERS); SNAP ON THE PROVIDED
WATER PROOF CAP

SEE WIRING ON NEXT PAGE

WIRING:

BATTERIES SHALL BE CONNECTED
BEFORE THE POWER IS SUPPLIED
TO THE FIXTURE

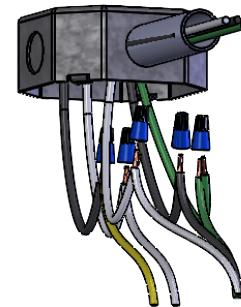
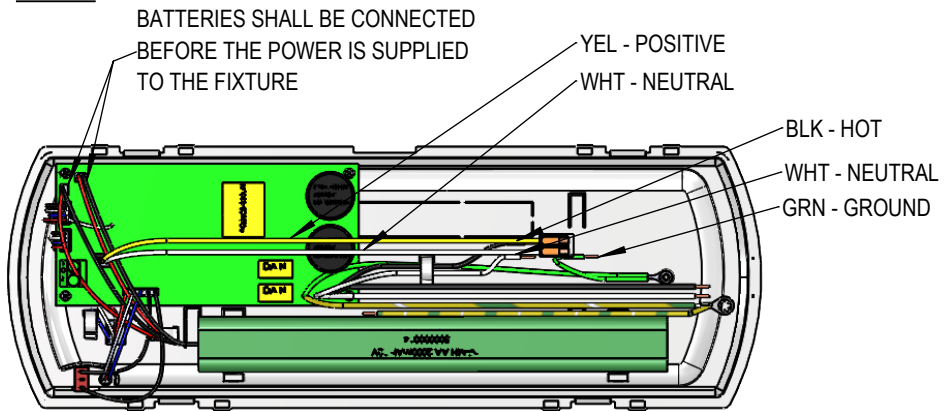

BLACK..... (HOT)
WHITE..... (NEUTRAL)
GREEN..... (GROUND)

IF WALL • SWITCH IS BEING USED,
REMOVE THE CONNTECTOR ON
YELLOW & WHITE AND
CONNECTED TO WALL SWITCH

WALL MOUNT LED ORIENTATION (23°/23°)

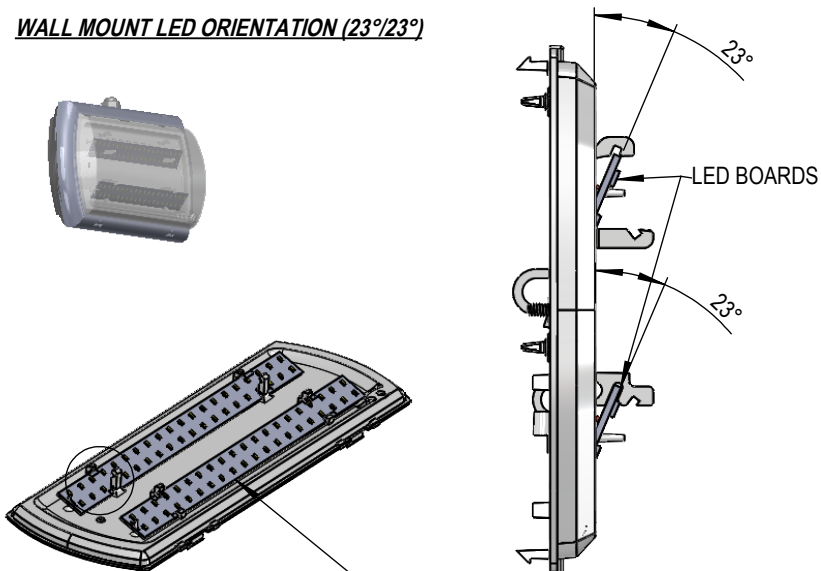

Proper replacement of a part removed for user
maintenance.
Remplacement correct d'une pièce retirée pour la
maintenance de l'utilisateur.

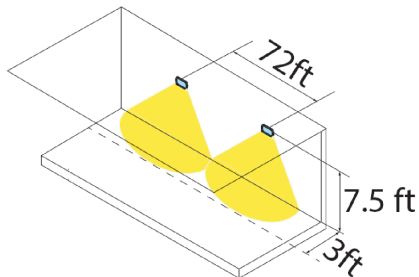
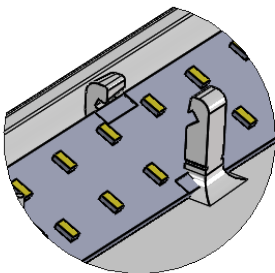

CEILING MOUNT LED ORIENTATION (35°/35°)

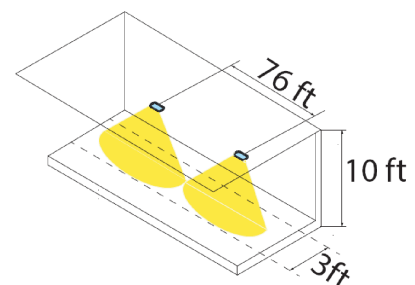
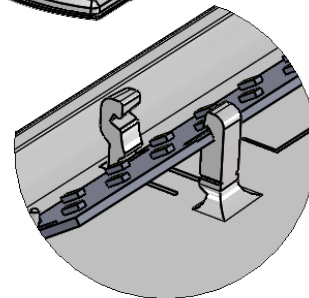
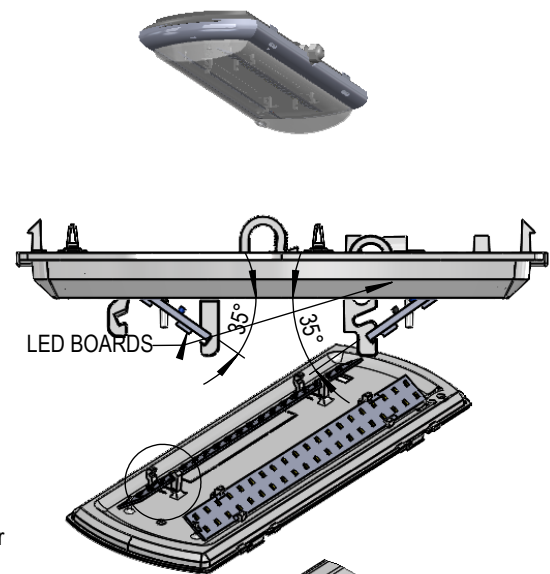

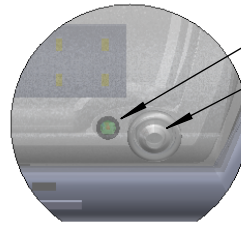
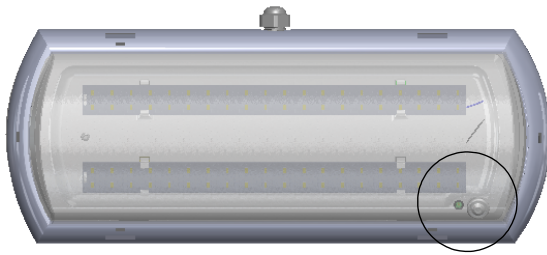

LED INDICATOR
TEST SWITCH
NORMALLY CLOSE (NC)



STEADY GREEN:
FLASHING RED/GREEN:
STEADY RED:

NORMAL OPERATION
HIGH CHARGING
BATTERY DISCONNECTED

FOR NON-AUTO-TEST VERSION

SE - Press and hold the test switch; LED strips should be ON.

FOR AUTO-TEST VERSION

All information beyond this point is for Auto-Test version

INSTRUCTIONS IMPORTANT SAFEGUARDS

When using electrical equipment, basic safety precautions should always be followed including the following:

1. READ AND FOLLOW ALL SAFETY INSTRUCTIONS.
2. Disconnect power before performing work on electrical equipment.
3. Do not let power cords touch hot surfaces and do not mount near gas or electric heaters.
4. Use caution when servicing batteries. Battery acid can cause burns to skin and eyes. If acid is spilled on skin or eyes, flush with fresh water and contact a physician immediately.
5. Equipment should be mounted in locations and at heights where unauthorized personnel will not readily subject it to tampering.
6. The use of accessory equipment not recommended by Beghelli Inc. may cause an unsafe condition and will void the unit's warranty.
7. Do not use the equipment for other than its intended purpose.
8. Servicing of this equipment should be performed by qualified service personnel.
9. SAVE THESE INSTRUCTIONS!

INSTRUCTIONS

After unit is properly installed according to Installation Instruction Sheet and with AC power supplied, the LED strips will be ON if it is a Normally On fixture (SA), the dual color LED indicator will be flashing red/green, until the battery is fully charged, and the self-diagnostic test function will automatically initiate. The dual color indicator points out the current unit status. The green color indicates the normal service/ green blinking indicates testing. The red color indicates the service alert, please refer to Diagnostic Display for detail. The green/red flash indicates the unit under charging. The indicator will be off at emergency mode.

SELF-DIAGNOSTIC SERVICE

The self-diagnostic function is factory pre-set. Any field adjustments are not required. The automatic self-diagnostic performs the following tests and the internal counter will begin from the date of installation:







- i) 5 minutes discharge and self-testing every 30 days: after AC power is applied.
- ii) 90 minutes discharge and self-testing every 6 months; after AC power is applied.

At all times the following are being monitored: Battery disconnection, LED failure, battery charging operation and the battery test failure.

NOTE: To change the self-testing time cycle OFF the fixture at the desired time.

DIAGNOSTIC DISPLAY

The Auto-Test Self-Diagnostics provides a visual indication of unit status via a multi-colored LED. The LED may indicate just one or any combination of various conditions as follows:

	STEADY GREEN:	NORMAL OPERATION
	FLASHING GREEN:	TESTING UNDER WAY
	FLASHING RED/GREEN:	HIGH CHARGING
	STEADY RED:	BATTERY DISCONNECTED
	FLASHING RED:	BATTERY TEST FAILURE
	RED DOUBLE BLINK:	BATTERY CHARGING FAILURE
	RED THREE BLINK:	LED FAILURE

MANUAL TESTING

The unit also provides manual testing by pressing the test button as follows. The testing can be stopped by pushing the button during the manual testing.

1. **30 sec. test:** Press **TEST** button **two times** (within 3 sec.)
 - The **GREEN** light will start flashing after 3 sec. and continue flashing during the remaining of the 30 sec. test.
 - If two presses of **TEST** button are not completed within 3 sec., this manual test will be ignored.
 - **This test is always allowed.**
2. **15 min. test:** Press **TEST** button **three times** (within 3 sec.)
 - The **GREEN** light will start flashing after 3 sec. and continue flashing during the remaining of the 15 min. test.
 - If three presses of **TEST** button are not completed within 3 sec., this manual test will be ignored.
 - **This test is always allowed.**
3. **90 min. test:** Press **TEST** button **four times** (within 3 sec.)
 - The **GREEN** light will start flashing after 3 sec. and continue flashing during the remaining of the 90 min. test.
 - If four presses of **TEST** button are not completed within 3 sec., this manual test will be ignored.
 - **This test is always allowed when battery is fully charged, diagnostic LED shows steady GREEN.**

Manual test can be stopped/aborted at any time by pushing **TEST** button **once** (lasting > 5 sec.), during the manual testing.

Note: MANUAL Test Modes of Ni-MH Charger Unit could be initiated only if any periodical Auto-Test is not under way. Otherwise pushing **TEST** button will be ignored.

If the battery fails on any of the above tests, an alarm signal of "Flashing Red" LED will be activated and displayed at all time until the LED board is reset, or any test has passed again.

If the diagnostic LED indicator does not light or the board malfunctions, resetting the LED board might clear all errors.

To reset the LED board:

2. Disconnect the battery and then disconnect the AC power.
3. Wait for 10 seconds, first reconnect the battery to the board and then resume AC power.

After exiting from MANUAL Test Mode a 24hr counter will be started to prevent any new AUTO/MANUAL test execution before 24hr of battery charging is performed or before battery is fully charged, whichever comes first, **with the exception of 5 min. Auto-Test, 30 sec. or 15 min. manual test.** However, any new emergency operation will be entered promptly, regardless of battery voltage level.

WARNING

4. Make sure that power is off before making any electrical connections!!!
5. Unused wires must be capped using provided wire nuts!

KEEP THESE INSTALLATION INSTRUCTIONS
CONSERVER CES INSTRUCTIONS D'INSTALLATION