

INSTALLATION INSTRUCTIONS

IMPORTANT SAFEGUARDS

Read & Follow All Requirements and Maintenance Instructions

1. Installation of photoluminescent exit sign requires a minimum of 5-foot-candles (54 lux) of light source (LED, fluorescent, metal-halide or mercury-vapor light) to illuminate the face(s) of the sign at all times of the building occupancy
2. This photoluminescent exit sign is intended for interior locations
3. External illumination source must be reliable and supplied by a circuit not controlled by automatic timers or sensors and whose controls are accessible only to authorized personnel; External illumination source is to be energized at all times during building occupancy
4. Lighting levels on the sign face(s) should be confirmed after any change in external lighting types or levels
5. Equipment should be mounted in locations and at heights where it will not be subjected to tampering by unauthorized personnel
6. The use of accessory equipment not recommended by Beghelli Inc may cause an unsafe condition and will void the unit's warranty
7. It is recommended that periodic visibility tests be performed in accordance with all applicable codes
8. Do not use this equipment for other than its intended purpose
9. Cleaning of the sign face(s) with a damp cloth is recommended during monthly inspections
10. Installation and servicing of this equipment should be performed by a qualified installer familiar with the product and the hazards involved

NOTE: THIS PRODUCT MUST BE INSTALLED IN ACCORDANCE WITH THE APPLICABLE INSTALLATION CODE BY A PERSON FAMILIAR WITH THE CONSTRUCTION AND OPERATION OF THE PRODUCT AND HAZARDS INVOLVED



WARNING

1. Install this sign indoors only, where not exposed to direct sunlight, liquid spray or temperatures outside the range of +10°C to 40°C



CAUTION

1. This sign should be charged for minimum 60 minutes to obtain full operational conditions

SAVE THESE INSTRUCTIONS

CEILING MOUNT

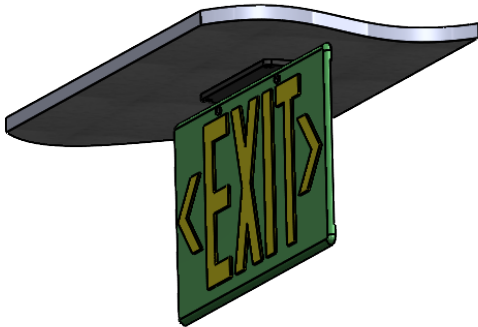

1. Position the Mount Bracket on the ceiling at the desired location
2. Mark and drill the hole locations on the ceiling for Insert
3. Secure the Mount Bracket on the ceiling with Mount Screws (provided)
4. Attach EXIT Panel to Mount Bracket using Panel Screws & Hex nuts

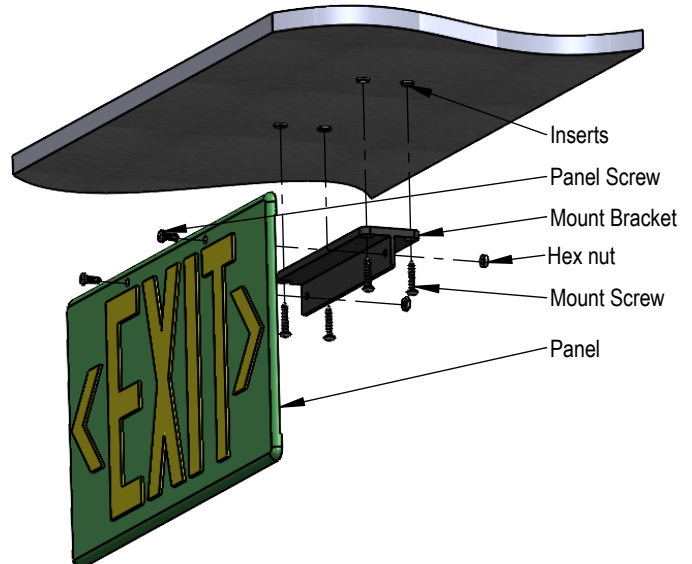
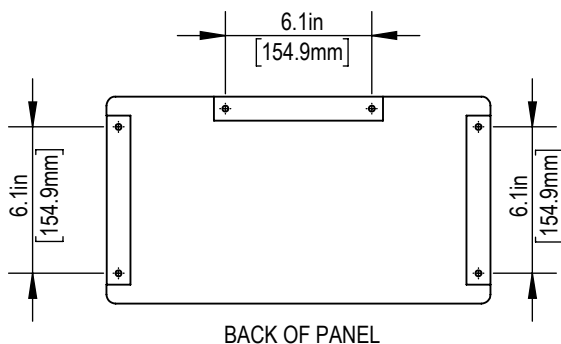

END MOUNT

1. Repeat the same procedures as ceiling mount



LEFT



RIGHT

PENDANT MOUNT

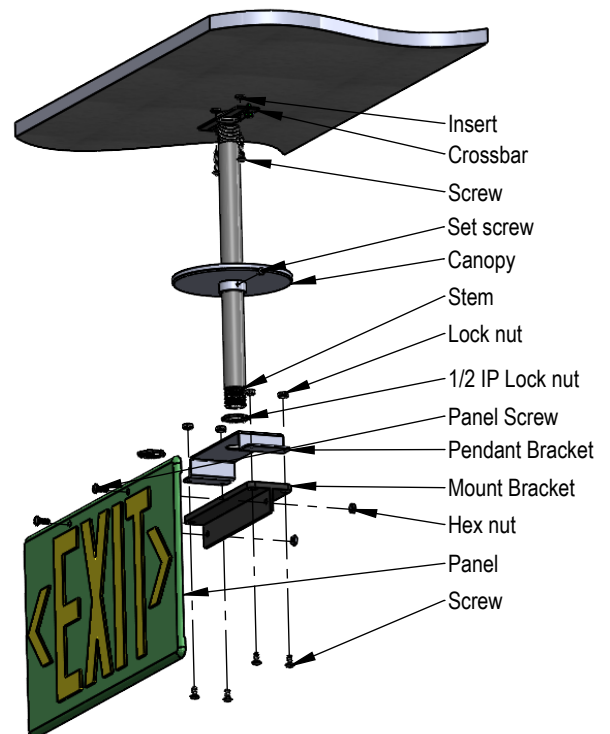

1. Position Crossbar on the ceiling at the desired location
2. Mark and drill the hole locations on the ceiling for Insert (by others)
3. Install Crossbar on ceiling
4. Attach Stem to Crossbar & Canopy to Stem secure the Canopy with set screw
5. Assemble the EXIT SIGN together (see pg 1.)
6. Attach Pendant Bracket to EXIT SIGN with provided Screws & Lock nuts
7. Attach Complete EXIT SIGN with Pendant Bracket to Stem using 1/2 IP Lock nuts

Components sold separately

- Canopy Kit - consists of Canopy, CrossBar & 1/2IP Lock nut
- Stem (specify length)