

IMPORTANT SAFEGUARDS

Read & Follow All Safety Instructions

When using electrical equipment, basic safety precautions should always be followed including:

1. Disconnect power before performing work on electrical equipment
2. Suitable for use outdoors and in wet locations
3. Do not mount in hazardous locations nor near gas or electric heaters
4. Do not let power cords touch hot surface
5. Equipment should be mounted in locations and at heights where it will not be subjected to tampering
6. The use of accessory equipment not recommended by Beghelli Inc. may cause an unsafe condition, and will void the unit's warranty
7. Do not use this equipment for other than its intended purpose
8. Servicing of this equipment should be performed by qualified service personnel
9. Allow battery to charge for 24 hours before first use
10. DO NOT install in unstable, loose or breakable surfaces
11. DO NOT let objects impact or exert excessive force on the surface of the fixture

SAVE THESE INSTRUCTIONS!

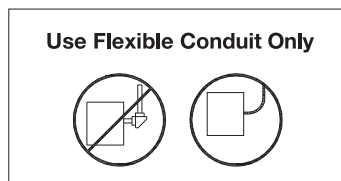

MAINTENANCE

Battery will have to recharge if the product is kept in stock for over 12 months. We recommend that the equipment be tested regularly in accordance with local codes. Replace the batteries as needed if the discharge time is less than 90 minutes.

OPERATION

Press the test button. The LED heads will turn on and the LED indicator will turn off. When releasing the test switch, the LED indicator will turn on and the LED heads will turn off.

TROUBLESHOOTING GUIDE

If LED lamps or LED indicator do not illuminate, check the following:

1. Check AC supply - verify that unit has had 24 hours AC supply
2. Check the battery connection- unit is shorted or battery is not connected
3. Discharge battery, then permit unit to charge for 24 hours before re-test
4. If above troubleshooting hints do not solve problem, contact factory for assistance

MOUNTING INSTRUCTIONS

Mounting Height

BBXWSECL
BBXWSEHO

Max. mounting height 40 ft
Max. mounting height 77 ft

Open Fixture (see Fig. 1)

- Use Philips screwdriver to loosen 2 screws per Fig 1
- Use flat blade screwdriver, insert into 2 middle slots and remove clear cover from back plate
- Use flat blade screwdriver, insert into the two slots and pry off front cover from back plate

Wall Mount - Back Power Feed (see Fig. 2)

- Once fixture is opened, knock out cable hole and appropriate mounting hole in back plate
- Feed utility AC wires through the cable hole of back plate
- Secure back plate to J-box by screws
- Connect the fixture wires to the utility AC wires using the wire nuts provided (Refer to the wiring diagram: connect the white wire to neutral, connect the black wire to the hot lead) and then press the wires back into the J-box
- Connect battery connector
- Snap the front cover onto the back plate
- Adjust the direction of the lamp heads, as needed
- Restore clear cover on the fixture
- Restore power and press test button, LED heads will turn on

Ceiling Mount - Top Power Feed (see Fig 3)

Refer to above **Wall Mount-Back Power Feed** instructions above, with one difference:

- Mount back plate on the ceiling surface instead of wall surface

Wiring Diagram

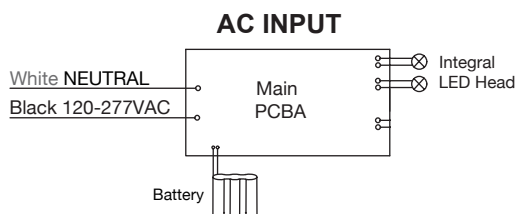

Open Fixture

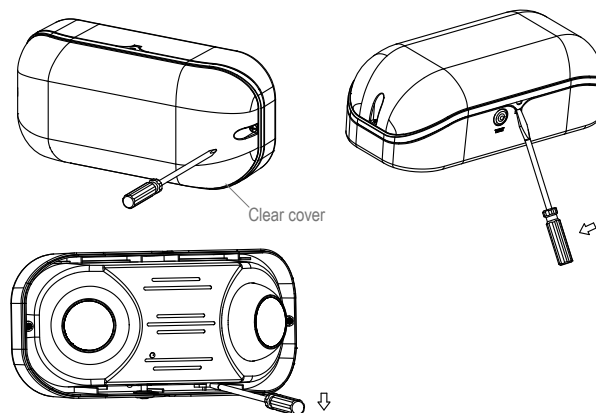

Fig 1

Wall Mount - Back Power Feed

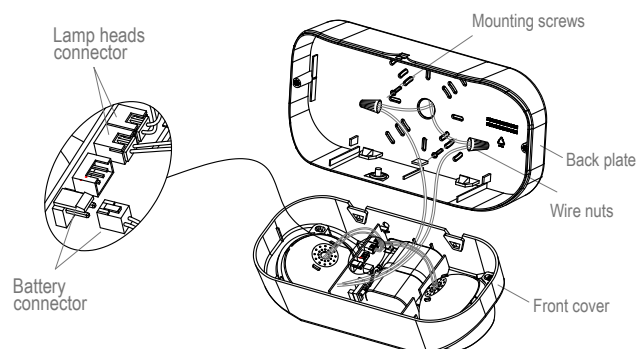

Fig 2

Ceiling Mount - Top Power Feed

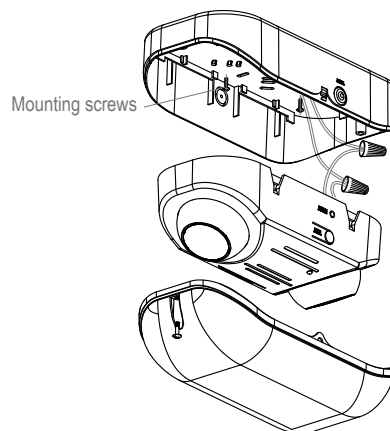







Fig 3

AUTOTEST INSTRUCTIONS

- 1. Install the BBXW according to the installation instructions**
- 2. When AC power is supplied to fixture, the unit will automatically initiate a self-test with self-diagnostics that will do the following:**
 - (1) Monitor for faults with battery, charger board, lamps and transfer circuit every 5 seconds
 - (2) Perform a 1-minute self-test every month
 - (3) Perform a 90-minute self-test every 12 months starting in the 12th month after installation
Note: ALL functions are factory pre-set (does not need field adjustment).

3. Dual color LED lamp indicator shows the following status:

- (1) Green color: ON/ Ready
Blinking: Testing
- (2) Red color: Service Alert
Blinking: Sequence below determines service required

	One blink ON/ pause 4 seconds	Battery is not connected
	Two blinks ON/ pause 4 seconds	Battery voltage drops below acceptable level
	Three blinks ON/ pause 4 seconds	Charger board circuit fault
	Four blinks ON/ pause 4 seconds	Transfer circuit fault
	Five blinks ON/ pause 4 seconds	Emergency lamp fault

TO RESET:

After resolving the fault of emergency equipment, press test button for 2 seconds without releasing to reset. LED indicator will show green.

4. For manual test, press test button as follows:

Press test button once	30 seconds test
Press test button twice (within 2 seconds)	3 minutes test
Press test button 3 times (within 2 seconds)	30 minutes test
Press test button 4 times (within 2 seconds)	90 minutes test