

INSTALLATION INSTRUCTIONS

IMPORTANT SAFEGUARDS

Read & Follow All Safety Instructions

When using electrical equipment, basic safety precautions should always be followed including:

1. Before starting the installation, disconnect the power by turning off the circuit breaker or by removing the appropriate fuse at the fuse box. Using the light switch to turn off the power is not sufficient to prevent electrical shock.
2. Do not use outdoors
3. Do not mount near gas or electric heaters
4. Use caution when servicing batteries. Battery acid can cause burns to skin and eyes. If acid is spilled on skin or eyes, flush acid with fresh water and contact a physician immediately
5. Equipment should be mounted in locations and at heights where it will not be subjected to tampering by unauthorized personnel
6. The use of accessory equipment not recommended by Beghelli Inc., may cause an unsafe condition, and will void the unit's warranty
7. Do not use this equipment for other than its intended purpose
8. Servicing of this equipment should be performed by a qualified service personnel
9. Allow battery to charge for 24 hours before first use

SAVE THESE INSTRUCTIONS

ELECTRICAL CONNECTIONS

- Make the proper connections with the supply wire
- If using 120VAC, connect the black and white wires to the building utility
- If using 277VAC, connect the orange and white wires to the building utility
- Cap off unused wires - In all cases, use standard wire nuts to connect to wires

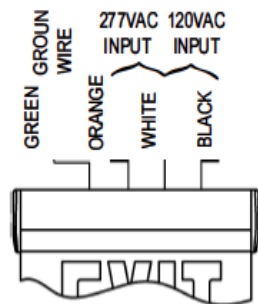

DETERMINE DIRECTION

- If indicator is needed, keep indicator and remove instruction film
- If indicator is not needed, remove both indicator and instruction film



UNIVERSAL COLOR

- The product's default setting is red
- Slide the knob of the slider switch to the opposite side to change the color to green

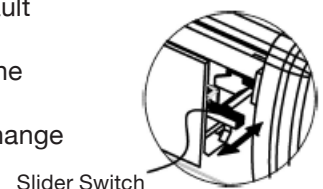

Mounting Instructions

Note: First turn off electricity

Surface Ceiling & Wall Mounting

1. Attach crossbar to junction box (TM8# 32*-1)
2. Use screwdriver to open front cover to connect battery connector
3. Red exit sign can change to green, if needed (See Universal Color on pg 1)

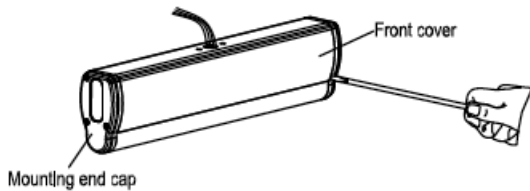

4. Feed AC supply wires through the center hole on the canopy
5. Assemble canopy onto main body assembly with (2) PM4*12 screws (supplied) and make proper wire connection (SEE ELECTRICAL CONNECTIONS)
6. Use (2) PM4-40 screws (supplied) to tighten canopy to crossbar

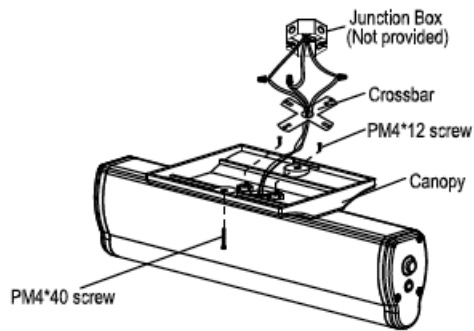

7. Gently insert EXIT panel into main body assembly. If EXIT panel is for single face, make sure EXIT letter direction is right



8. Determine direction for chevron placement (SEE DETERMINE DIRECTION)

8. This unit can be installed on any surface, you may rotate the EXIT panel in any angle from from 0° to 180°, When ceiling mounting is rotated 90°, it becomes Wall mounting.

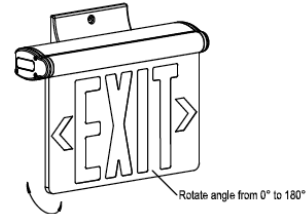

Surface End Mounting

1. Attach crossbar to junction box
2. Use screwdriver to open front cover to connect battery connector
3. Red exit sign can change to green exit sign, if needed (SEE UNIVERSAL COLOR)
4. Remove the hole plug from mounting and cap
5. Pull out all AC supply wires and feed wires through the center holes of mounting end cap and then through the canopy
6. Reference steps 5-9 in Surface Ceiling & Wall Mounting on this page for surface end mouing

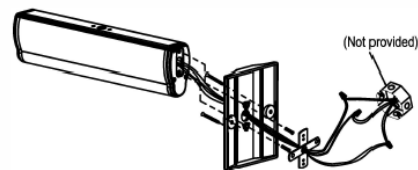

MAINTENANCE

Battery will have to recharge if product is kept in stock for over 9 months. The equipment should be tested regularly in accordance with local codes. Replace batteries, as needed, if discharge times do not schieve 90 minutes

OPERATION

Press the test button, unit will be illuminated by battery backup and the LED indicator will be turned off -- Release the test switc and LED indicator will be turned on.

TROUBLE SHOOTING GUIDE

If LED heads or LED indicator does not illuminate, check the following

1. AC supply - verify that unit has 24 hour AC supply
2. Battery Connection
3. Discharge battery and charge for 24 hour and then retest
4. If above troubleshooting hints do not solve the problem, contact facotry for assistance