

# CASTEX 320



## HAZARDOUS

■ The **CASTEX 320** is a hazardous location luminaire rated for use in:

- Class I, Division 1, Groups C, D
- Class I, Division 2, Groups A, B, C, D
- Class II, Division 1, Groups E, F, G
- Class II, Division 2, Groups F, G
- Class III
- UL1598 (Wet Location) & UL1598A (Marine)
- Temperature Code: T4

■ The **CASTEX 320** comes standard in gray with a surface/wall mount bracket.

■ **HOUSING:** Die-cast, ADC12 aluminum alloy body, 6mm thick, with marine grade RAL7040 powder coat finish.

■ **DIFFUSER:** 8 mm tempered glass 120° distribution. Other distributions available (40°, 60°, & 90°); contact factory for details.

■ **COLOR TEMPERATURE:** 5000K. Other color temperatures available (2200K to 7000K); contact factory for details.

■ **LUMENS:**

- VLO: 60W @ 7368 lm (EM: 15W @ 1842 lm)
- LO: 80W @ 8704 lm (EM: 15W @ 1632 lm)
- MO: 100W @ 12831 lm (EM: 15W @ 1925 lm)
- HO: 150W @ 18967 lm (EM: 15W @ 1897 lm)

■ **OPERATING TEMP:**

- HT (AC Only) -40°F to 131°F (-40°C to 55°C)
- SA (AC & EM) 14°F to 140°F (-10°C to 55°C)



■ **WEIGHT:** 15.4 lbs to 39.4 lbs (7kg to 17.9kg)

■ **APPLICATION:** The **CASTEX 320** is designed for impact resistance and is ideal for heavy industry such as mining, refineries, chemical, food, coastal marine facilities and corrosive applications.

## ORDERING INFORMATION

MODEL	OPERATION	OUTPUT	DIMMABLE	COLOR TEMP	INPUT	OPTIONS
HZ-CAS320	HT (AC only)	VLO	blank (no dimming)	WT50 <sup>2</sup> (5000K)	120-277V	BAA (Buy American Act)
	SA <sup>1</sup> (AC & EM)	LO	DIM (0-10V dimming)			EM <sup>4</sup> (remote emergency VLO & LO)
		MO				HZ-JBOX (J-box)
		HO				HZ-PK12 (12" pendant stem)

NOTE 1: Integral emergency available in MO & HO only

NOTE 2: Other Color temperatures available (2200K to 7000K). Contact factory.

NOTE 3: High voltage option available (200 to 480V). Contact factory.

NOTE 4: Remote emergency includes hazardous rated housing, remote mount up to 50 ft

NOTE: Surface/wall mount is standard

## DIAGRAM

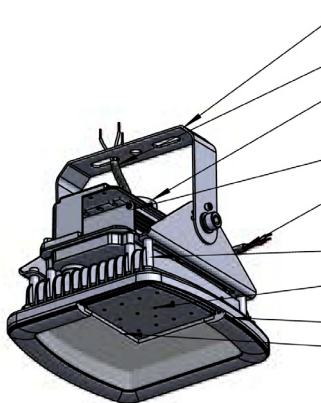

3mm THICK STEEL MOUNTING BRACKET (ADJUSTABLE) WITH GRAY POWDER COAT FINISH IS STANDARD.

18/3 - CONDUCTOR POWER CORD (AC INPUT); 6FT IN LENGTH.

CAST ALUMINUM DRIVER COMPARTMENT WITH GRAY POWDER COAT FINISH; WITH 3/4 NPT THREADED CONNECTION.

ELECTRONIC 0-10V DIMMING DRIVER FOR 120-277V 50/60Hz (10-100%); OPERATION. (SYSTEM POWER CONSUMPTION 60W & 80W).

18/2-CONDUCTOR LOW VOLTAGE CORD (DIMMING); 6FT IN LENGTH.

CAST ALUMINUM HEAT SINK WITH GRAY POWDER COAT FINISH.

LED CIRCUIT BOARD.

TRIM RING WITH SILVER POWDER COAT FINISH.

8mm THICK TEMPERED GLASS LENS.

## DIMENSIONS

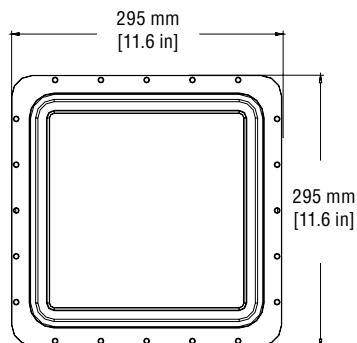

### SQUARE

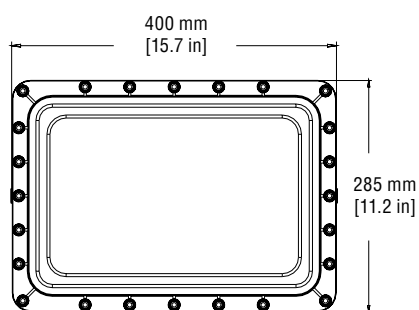
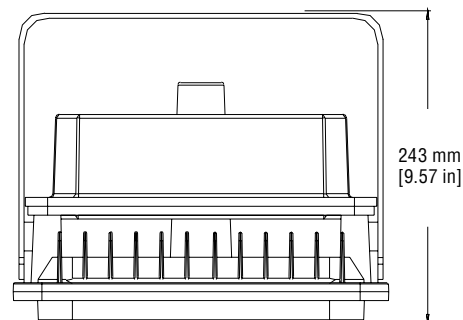
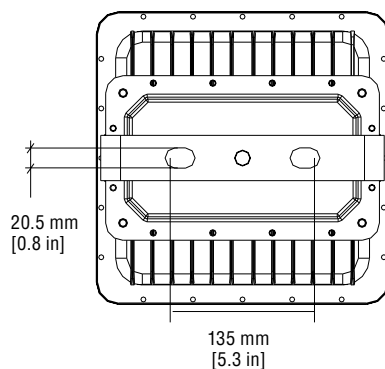

### RECTANGLE

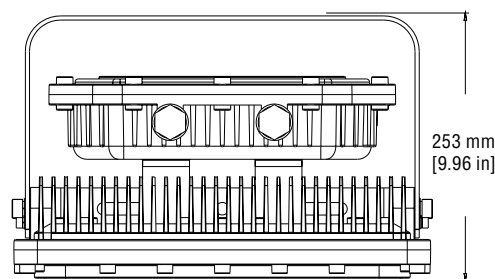
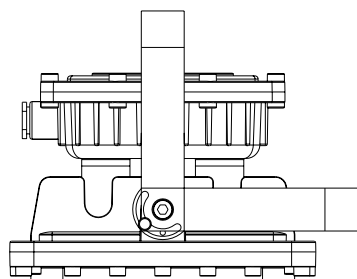

## MOUNTING OPTIONS

### Standard

(surface/wall mount bracket)  
(Aimable 90° both sides -22.5° increments.)

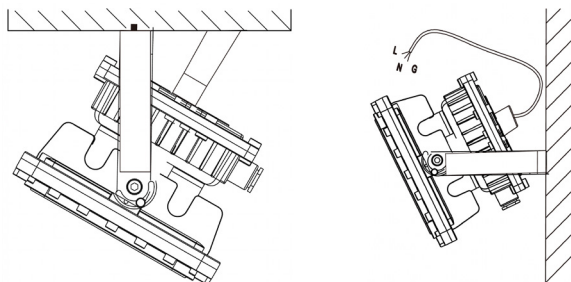

NOTE: Power cord cannot be exposed. Hazardous conduit or hazardous J-box mounting required.

### Pendant Kit

(HZ-PK12)

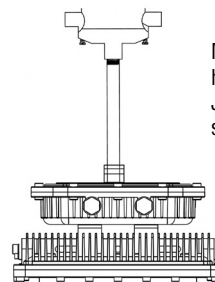

Note: PK does not include hazardous rated J-box. J-box must be ordered separately.

# CASTEX 320

## PHOTOMETRICS

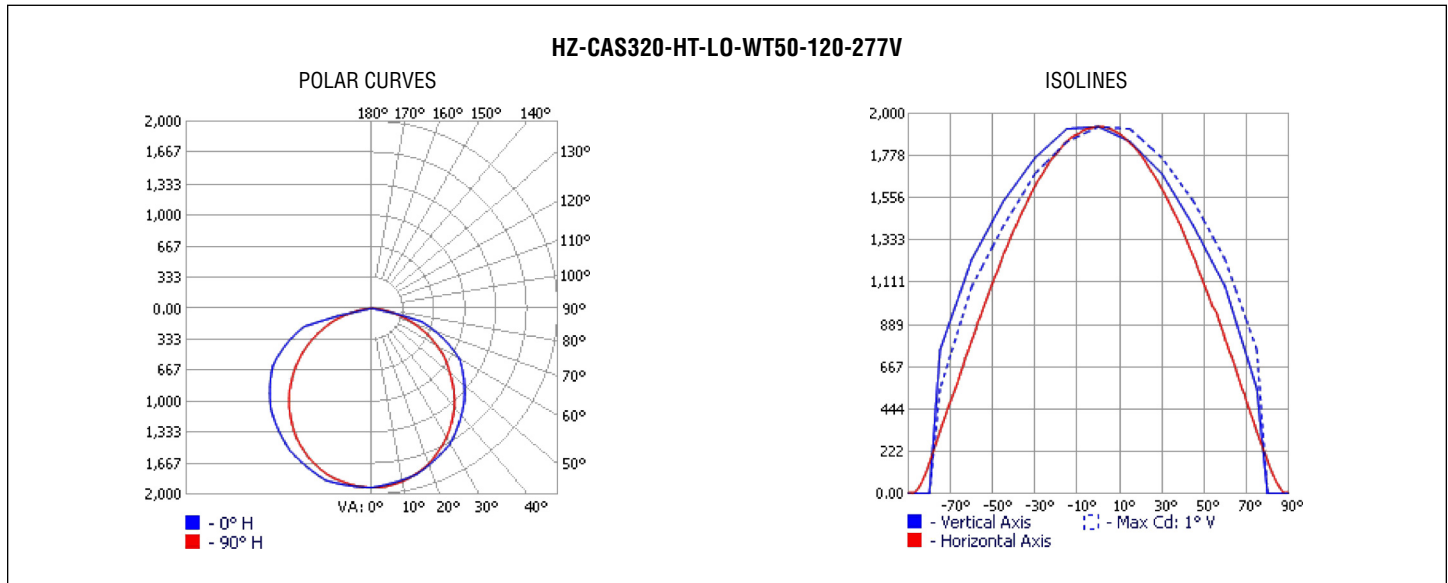

## ENERGY CHART

MODEL	EFFICACY	CONSUMPTION WATTAGE	LUMEN OUTPUT	CRI	L70 (HRS) TESTED	L70 (HRS) PROJECTED
HZ-CAS-320-HT-VLO-WT50-120-277V	122 lm/W	60	7368 lm	>70	>44,000	>72,000
HZ-CAS-320-HT-LO-WT50-120-277V	108 lm/W	80	8704 lm	>70	>44,000	>72,000
HZ-CAS-320-HT-MO-WT50-120-277V	128 lm/W	100	12831 lm	>70	>44,000	>72,000
HZ-CAS-320-HT-HO-WT50-120-277V	126 lm/W	150	18967 lm	>70	>44,000	>72,000

## ELECTRICAL RATING

PRODUCT	NOMINAL POWER (W)	AC CURRENT (A) AC VOLTAGE	FREQUENCY (HZ)	DC VOLTAGE (V)	DC CURRENT (MA)
HZ-CAS-320-HT-VLO	60	120 V   0.51   277 V   0.22	50/60	48	1250
HZ-CAS-320-HT-LO	80	0.68   0.29	50/60	48	1670
HZ-CAS-320-HT-MO	100	0.85   0.37	50/60	48	2090
HZ-CAS-320-HT-HO	150	1.28   0.55	50/60	48	3130

## DIMMER COMPATIBILITY

DIMMER	COMPATABILITY ON/OFF   DIMMING
LEVITON - AWRMG-7	YES   YES
LUTRON - DIVE - DVSTV	YES   YES

■ **WARRANTY:** 5 years, see website for full warranty details.