

INSTALLATION INSTRUCTIONS

IMPORTANT SAFEGUARDS

Read & Follow All Safety Instructions

When using electrical equipment, basic safety precautions should always be followed including:

1. Disconnect power before performing work on electrical equipment.
2. Do not use outdoors.
3. Do not mount near gas or electric heaters.
4. Do not let power cords touch hot surface.
5. Equipment should be mounted in locations and at heights where it will not be subjected to tampering.
6. The use of accessory equipment not recommended by Beghelli Inc., may cause an unsafe condition, and will void the unit's warranty.
7. Do not use this equipment for other than its intended purpose.
8. Servicing of this equipment should be performed by a qualified service personnel.
9. DO NOT install in unstable, loose or breakable surfaces.
10. DO NOT let objects impact or exert force on the surface of the fixture.

IMPORTANT

When relamping, only use lamps specified in the exit. Using other lamp types may result in trans- former damage or unsafe conditions. Battery (when applicable) in the unit may not be fully charged. After electricity is connected to the unit, let the battery charge up for at least 24 hrs. The normal operation of the unit should then take effect.

SAVE THESE INSTRUCTIONS!

WIRING DIAGRAMS

NOTE: Unused input lead must be properly insulated with wire nut or other approved method.

AC ONLY

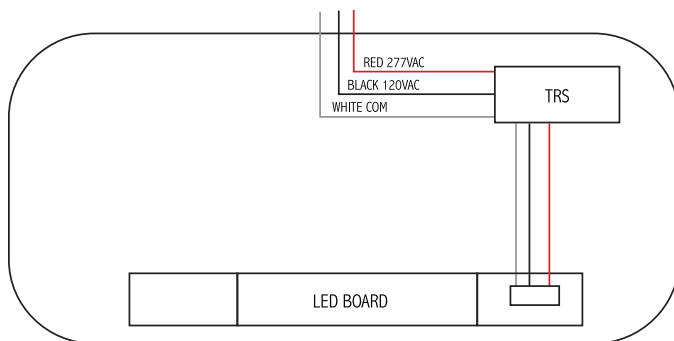

EMERGENCY

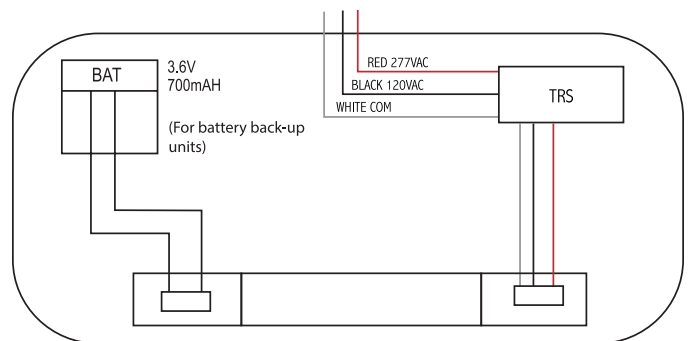

INSTALLATION (CEILING OR END WALL MOUNT)

1. Slide out front exit panel face plate & lens/filter by removing the screw on the bottom of the unit.
2. Remove the (3) KO's in either the side (for end wall mount) or top (for ceiling mount) of the fixture that lines up with the same holes on the CANOPY/J-BOX COVER. (Note: For CEILING MOUNT, you must remove the INTERNAL TRANSFORMER COVER on the inside top of the fixture. Please re-insert after installation.)
3. Using the (2) 1/2" long 8-32 screws and lock nuts, attach the canopy to the proper area of the exit sign (as shown in Fig. 1).
4. Determine if ROUND ADAPTER PLATE will be needed for proper orientation of the exit sign. If it is needed, install it now with the remaining (2) 1/2" lng 8-32 screws (as shown in Fig. 2).
5. Mount sign to the J-Box using the (2) 1-1/2" long 8-32 screws (Figure 2), making sure to route the AC SUPPLY wires into the fixture. Use the included 20" jumper wires if needed for this step.
6. Connect AC SUPPLY WIRES to fixture input wires. BLACK is 120V, RED is 277V, and WHITE is COM. Connect the battery (emergency models) after continuous AC power can be provided to the unit.
7. For emergency models only: connect bi-pin BATTERY CONNECTOR to PC BOARD.
8. Replace front panel and red lens and secure with bottom screw.

INSTALLATION (BACK MOUNT)

1. Slide out the front exit panel face plate and lens/filter by removing the screw on the bottom of the unit.
2. Determine which mounting holes will be used to mount the fixture to J-BOX and then punch out proper K/Os from the K/O pattern on the back panel of the housing.
3. Using the (2) 1/2" long 8-32 screws and lock nuts, attach the canopy to the proper area of the exit sign (as shown in Fig. 1).
4. Mount sign to the J-BOX using the (2) 1-1/2" long 8-32 screws, making sure to route the AC SUPPLY wires into the fixture. Use the included 20" jumper wires if needed for this step.
5. Connect AC SUPPLY WIRES to fixture input wires. BLACK is 120V, RED is 277V, and WHITE is COM. Connect the battery (emergency models) after continuous AC power can be provided to the unit.
6. For emergency models only: connect bi-pin BATTERY CONNECTOR to PC BOARD.
7. Replace front panel and red lens and secure with bottom screw.

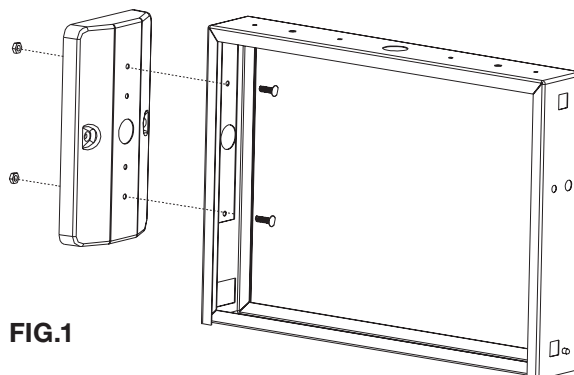

FIG.1

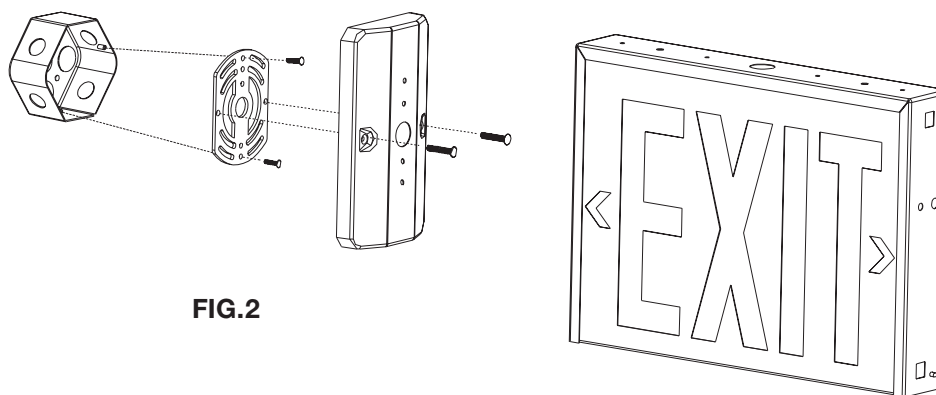

FIG.2